

COMMITTED TO  
EXCELLENCE



## PRE-ENGINEERED BUILDINGS

### PIONEERS IN PRE-ENGINEERED BUILDINGS & STEEL STRUCTURES

- Established in 1976 - A group company of Alghanim Industries - Kuwait.
- Market leader in the Pre-Engineered Steel Buildings (PEB) market - Executed over 65,000 landmark projects globally
- Recognized as one of the largest PEB manufactures in the world with 400,000 MT per annum capacity- 5 factories across Kuwait, India, UAE and Vietnam.
- Established Global Centre of Engineering Excellence at India where world's best practices are implemented to quote most optimized design for any type of building
- 70 Sales offices & 300 builders spread across the Middle East & Africa, India, Southeast Asia and parts of Europe.
- Executed World's single largest PEB for Renault Nissan Automotive manufacturing facility in India

# PRE-ENGINEERED BUILDINGS

## PEB Skeleton Structure

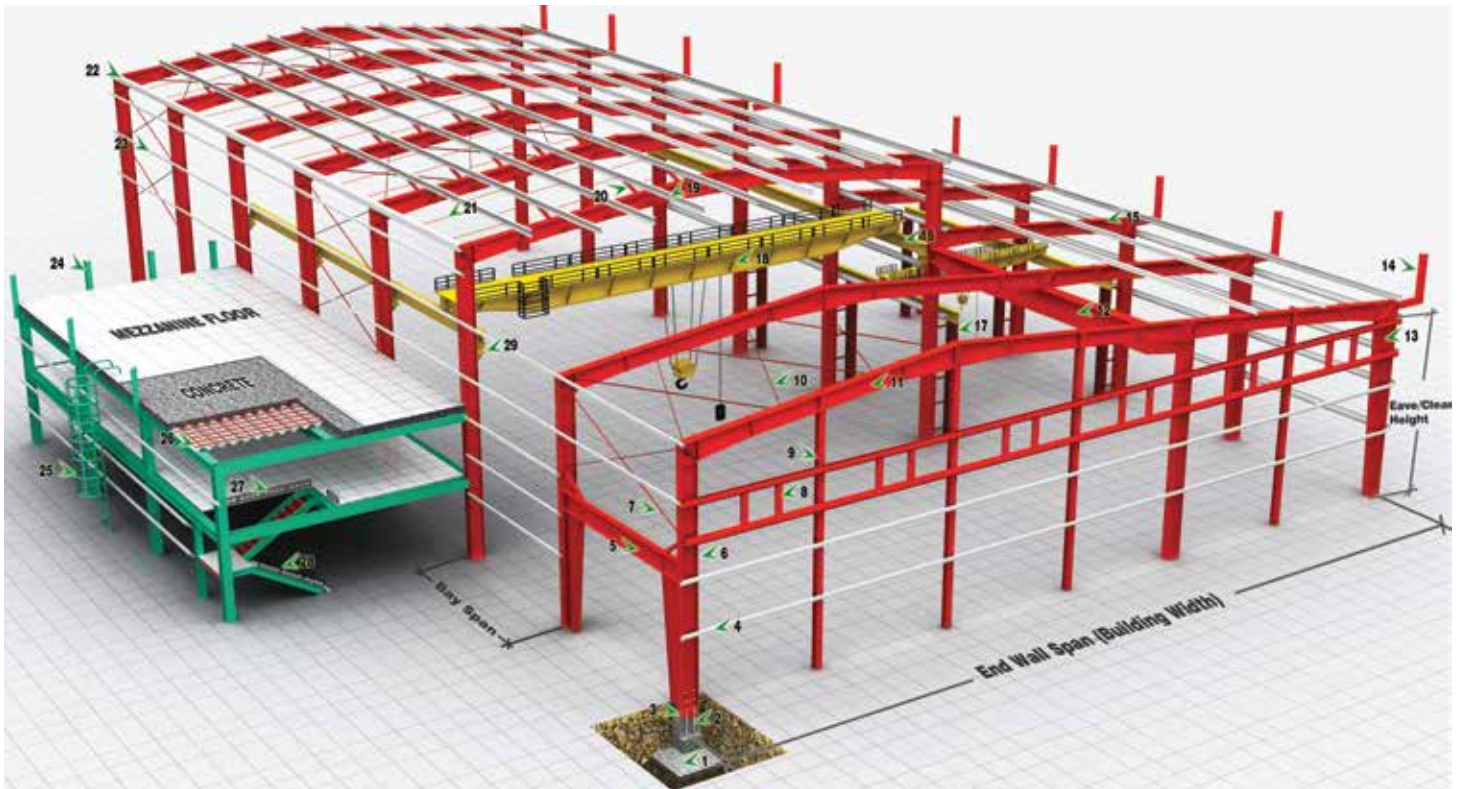

- |                                  |                                   |                    |                                       |
|----------------------------------|-----------------------------------|--------------------|---------------------------------------|
| 1. Concrete Footing              | 8. Framed Opening (Window/Louwer) | 15. Lean Too Frame | 22. Eave Stud                         |
| 2. Anchor Bolts                  | 9. End Wall Wind Column           | 16. Crane Beam     | 23. Side wall Girt                    |
| 3. Base Plate                    | 10. Roof Bracing (Angle/Rod/Pipe) | 17. Crane Column   | 24. Flush Fascia Frame                |
| 4. End Wall Girt                 | 11. Main Frame Rafter             | 18. EOT Crane      | 25. Cage Ladder                       |
| 5. Portal Bracing                | 12. Jack Beam                     | 19. Roof Purlin    | 26. Deck Panel with Steel Mesh        |
| 6. Main Frame Straight Column    | 13. Main Frame Tapered Column     | 20. Flange Brace   | 27. Hand Rail (Steel)                 |
| 7. Wall Bracing (Angle/Rod/Pipe) | 14. Cantilevered Fascia Frame     | 21. Sag Rod        | 28. Staircase Checker Plate/C Channel |
|                                  |                                   |                    | 29. Crane Bracket                     |

## PEB Advantages

Faster construction

Economical

Space flexibility - Larger spans for flexible interior design

High quality and durability

Environmentally friendly

Adjustable design - Can cater to future expansions (vertical and horizontal)

Minimal maintenance

Seismic (earthquake resistant) design

## PEB Applications

Industrial Buildings

Warehouses

Showrooms/Supermarkets

Offices/Schools/Hospitals

Metro Stations

Leisure Buildings

Shipyards

Cold Storages

Shelters

Car Parks

Aircraft Hangars

## Projects



Penrith Trade Center, Australia



Soft Drink Factory, Myanmar



Universal Menswear, Bangladesh



Popular Feedmill, Philippines



Panasonic Factory, Vietnam



Hemaraj Factory, Thailand



Wilmar New CPC Building, Indonesia





[www.kirbyinternational.com](http://www.kirbyinternational.com)

Follow us at   



#### **Middle East & Africa Corporate Office & Kuwait Plant**

Kirby Building Systems - Kuwait  
Mina Abdullah Industrial Area  
P.O. Box 23933 Safat, 13100, Kuwait

Tel.: +965 2326 2800  
Fax: +965 2326 1793 / 8  
Email: [kirbymarketing@alghanim.com](mailto:kirbymarketing@alghanim.com)

#### **Ras Al Khaimah Manufacturing Plant, UAE**

Kirby Building Systems - UAE LLC,  
Al Jazeera Industrial Area II,  
Behind RAK Ceramics,  
PO Box No. 6624,  
Ras Al Khaimah, UAE.

Tel.: +971 7204 3333  
Fax: +971 7244 7830  
Email: [kirbyrak@alghanim.com](mailto:kirbyrak@alghanim.com)

#### **India Corporate Office & Hyderabad Plant**

Kirby Building Systems India Ltd.  
Plot No 8-15, IDA Phase III,  
Pashamylaram, Medak Dist. - 502 307  
Telangana, India

Tel.: +91 8455 224401 / 02 / 03 / 04  
Fax: +91 8455 224419 / 27  
Email: [kirby@kirby-india.com](mailto:kirby@kirby-india.com)

#### **Haridwar Plant, India**

Kirby Building Systems India (Uttaranchal)  
Pvt. Ltd.  
Plot No 2, Sector 11,  
Integrated Industrial Estate,  
Haridwar, Uttarakhand - 249403, India

Tel: +91 1334 235317, 235318, 235319  
Fax: +91 1334 235314, 235397  
Email: [kirby@kirby-india.com](mailto:kirby@kirby-india.com)

#### **Southeast Asia Corporate Office & Vietnam Plant**

Kirby South East Asia Co., Ltd.  
7<sup>th</sup> Floor, Phuoc Thanh Building,  
199 Dien Bien Phu, Ward 15,  
Binh Thanh District,  
Hochiminh City, Vietnam

Tel.: +84 5422 1155  
Fax: +84 5422 1156  
Email: [sales@kirby.vn](mailto:sales@kirby.vn)

**Kirby is a wholly owned subsidiary of Alghanim Industries**



Alghanim Industries,  
P.O. Box 223, Safat,  
Kuwait 13003